

PART NO.	CONDUCTOR MATERIAL	CURRENT
FA12348	COPPER	185 AMPS
FA12348-02	MOLYBDENUM	93 AMPS
FA12348-03	NICKEL	56 AMPS
FA12348-04	304 STN STL	12 AMPS

RATINGS	
VOLTAGE:	12KV DC
CURRENT:	SEE TABLE AT LEFT
TEMPERATURE:	-269°C TO 450°C

PROPRIETARY AND CONFIDENTIAL

THE INFORMATION CONTAINED IN THIS DRAWING IS THE SOLE PROPERTY OF SOLID SEALING TECHNOLOGY. ANY REPRODUCTION IN PART OR AS A WHOLE WITHOUT THE WRITTEN PERMISSION OF SOLID SEALING TECHNOLOGY IS PROHIBITED.

THIRD ANGLE PROJECTION

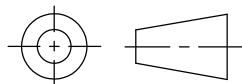

TITLE:

12KV FEEDTHROUGH



**SOLID SEALING TECHNOLOGY, INC.**

REV.	APP'D	DATE	SCALE 1:1	DIMENSIONS IN INCHES [mm]	DRAWN	JM	12/28/2005
A1	MH	03/21/2006	FTST0036-0ST		ENG APPR.	MH	03/21/2006

PART NO. (SEE TABLE) REV. A

SALES DWG NO. FA12348SL REV. A1