

PART NO.	CONDUCTOR MATERIAL	CURRENT
FA11643	COPPER	27 AMPS
FA11643-02	MOLYBDENUM	13.5 AMPS
FA11643-03	NICKEL 200	8.2 AMPS
FA11643-04	304 STN STL	1.8 AMPS

RATINGS	
VOLTAGE:	3KV DC
CURRENT:	SEE TABLE AT LEFT
TEMPERATURE:	-25°C TO 205°C

PROPRIETARY AND CONFIDENTIAL

THE INFORMATION CONTAINED IN THIS DRAWING IS THE SOLE PROPERTY OF SOLID SEALING TECHNOLOGY. ANY REPRODUCTION IN PART OR AS A WHOLE WITHOUT THE WRITTEN PERMISSION OF SOLID SEALING TECHNOLOGY IS PROHIBITED.

THIRD ANGLE PROJECTION

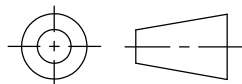

TITLE:

TWO 3KV FEEDTHROUGHS

PART NO. (SEE TABLE) REV. A



SOLID SEALING TECHNOLOGY, INC.

SALES DWG NO. FA11643SL REV. A1

REV.	APP'D	DATE	SCALE 1:1	DIMENSIONS IN INCHES [mm]	DRAWN	JM	12/27/2005
A1	MH	03/21/2006	MPCL0015-0ST		ENG APPR.	MH	03/21/2006